

Appendix

Capital Project 23-2300E2 Proposed detour plan

Rutherford Road South sanitary sewer lining and maintenance hole repairs from Queen Street East to 450m south of Clark Boulevard
City of Brampton, Ward 3

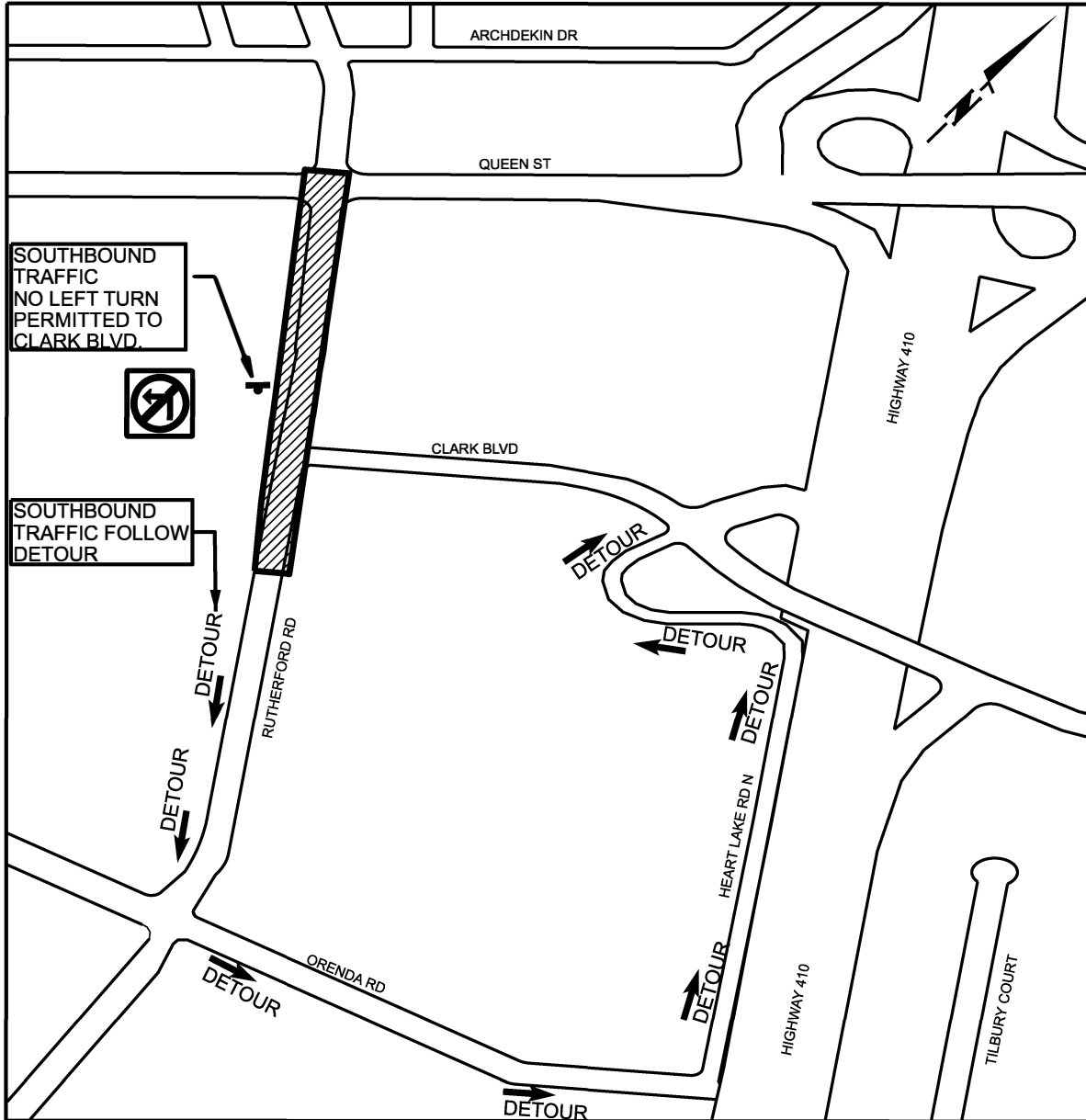

Legend:



CONSTRUCTION ZONE



NO LEFT TURN PERMITTED SIGN