

Project 19-2410

Erin Mills Trunk Sewer Rehabilitation

The Chase - Partial Road Closure

Phone: 905-791-7800 ext: 4409

Email: construction@peelregion.ca

Councillor: B. Butt (ward 11), M. Mahoney (ward 8), Mississauga

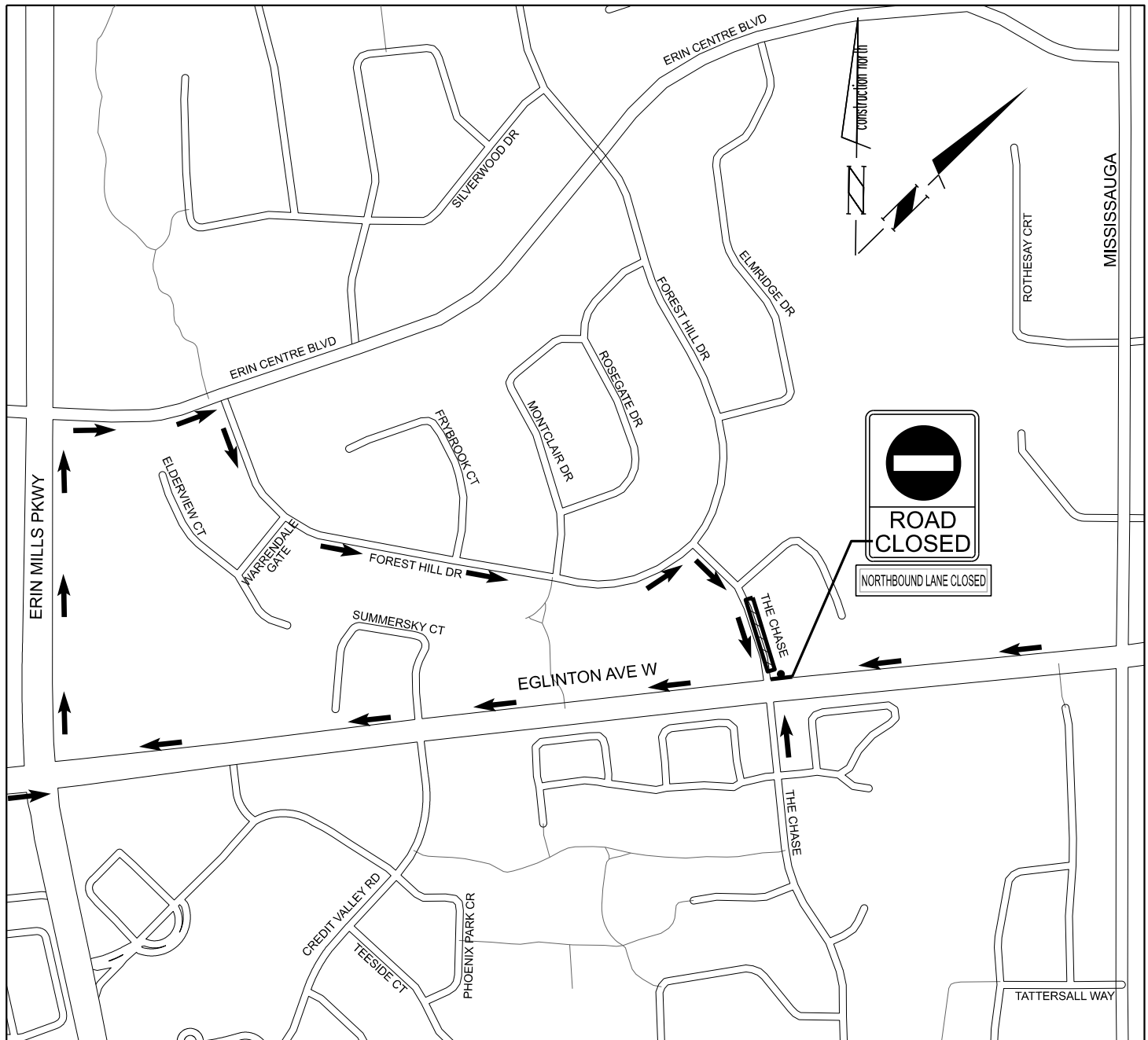

Legend:



Prop. work area



Detour routes

Project 19-2410



Erin Mills Trunk Sewer Rehabilitation

Eglinton Ave W - Lane Closure (Phase 1)

Phone: 905-791-7800 ext: 4409

Email: construction@peelregion.ca

Councillor: B. Butt (ward 11), M. Mahoney (ward 8), Mississauga

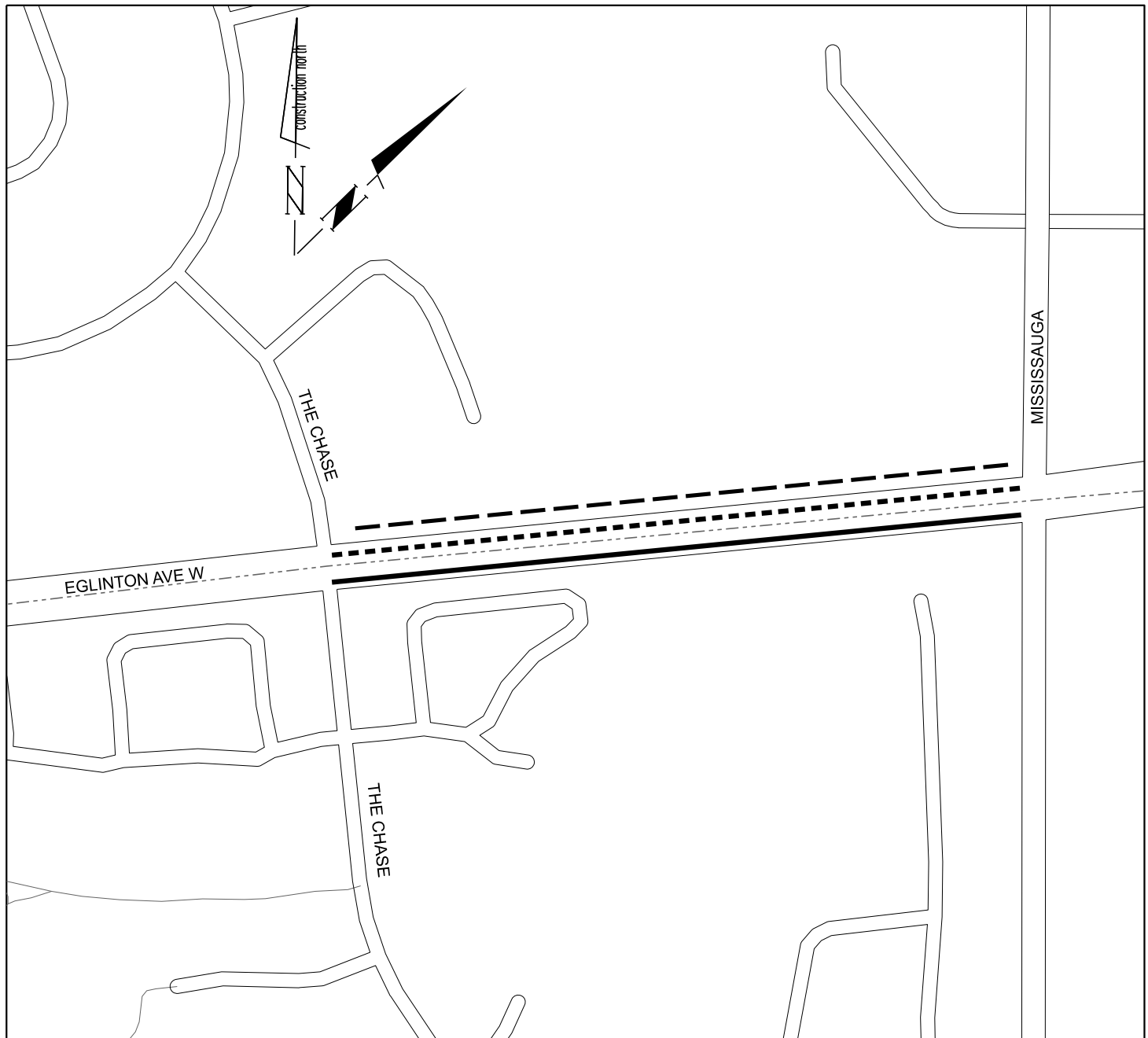

Legend:

- — — Prop. sanitary sewer rehabilitation
- — — Bypass pipes
- Lane closed
- Lane open

Lane Closure:

Eglinton Ave W (Mississauga Rd to The Chase)
Westbound outermost (right) lane to be closed

Project 19-2410



Erin Mills Trunk Sewer Rehabilitation

Eglinton Ave W - Lane Closure (Phase 2)

Phone: 905-791-7800 ext: 4409

Email: construction@peelregion.ca

Councillor: B. Butt (ward 11), M. Mahoney (ward 8), Mississauga

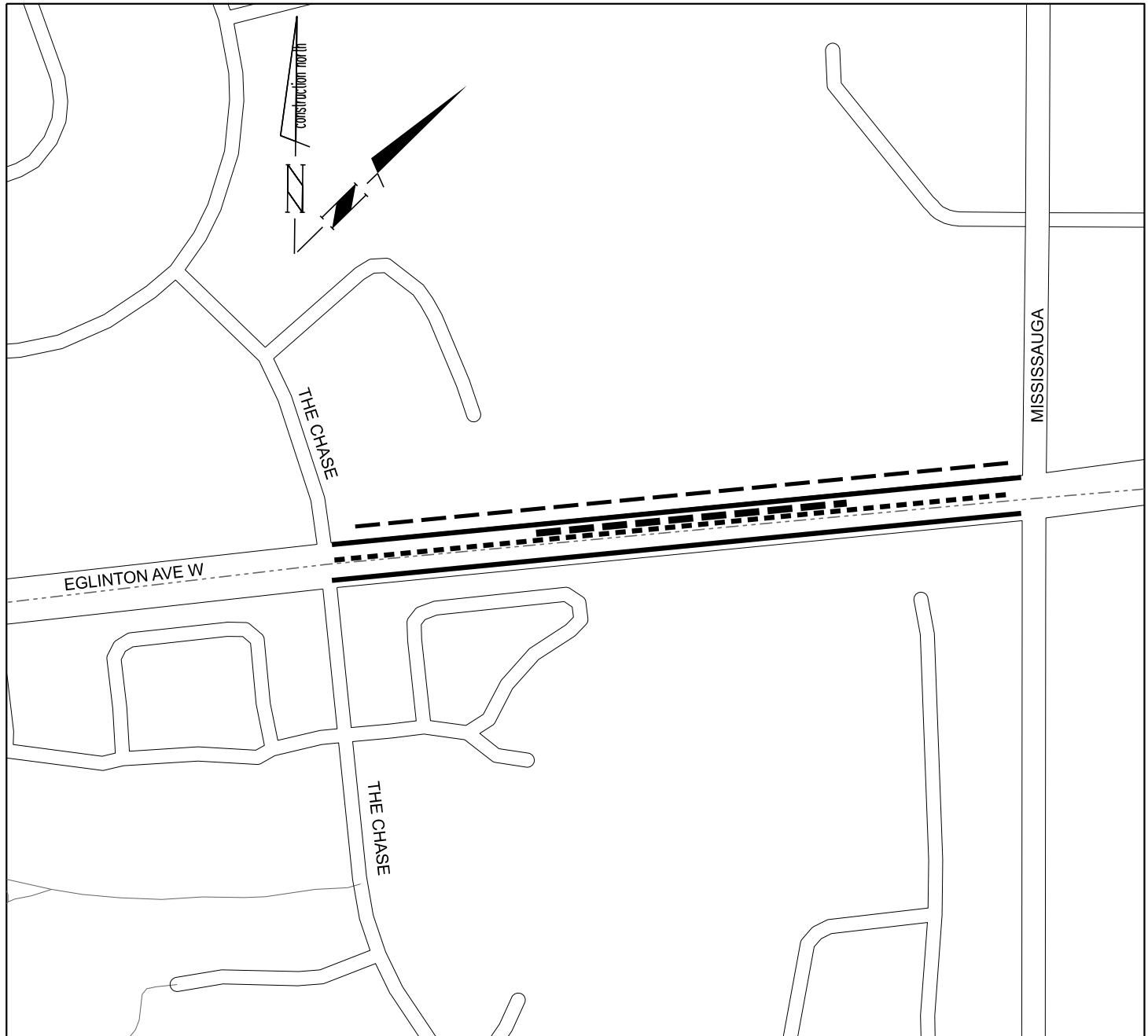

Legend:

- — —** Prop. sanitary sewer rehabilitation
- — —** Bypass pipes
- — —** Lane closed
- — —** Lane open

Lane Closure:

Eglinton Ave W (Mississauga Rd to The Chase)
Westbound innermost (left) lane to be closed