

NOTES:

1. ALL BRACKETS AND BOLTS ARE TO BE STAINLESS STEEL.
2. INSTALL STAINLESS STEEL CABLE STRAIN RELIEVER TO PROTECT CABLE.
3. CONDUIT (AND CABLE) ENTRY CONNECTION TO THE INSTRUMENT SHALL BE 900MM FLEXIBLE. THE BALANCE IN RIGID CONDUIT.

LEVEL FLOAT SWITCH MOUNTING DETAILS

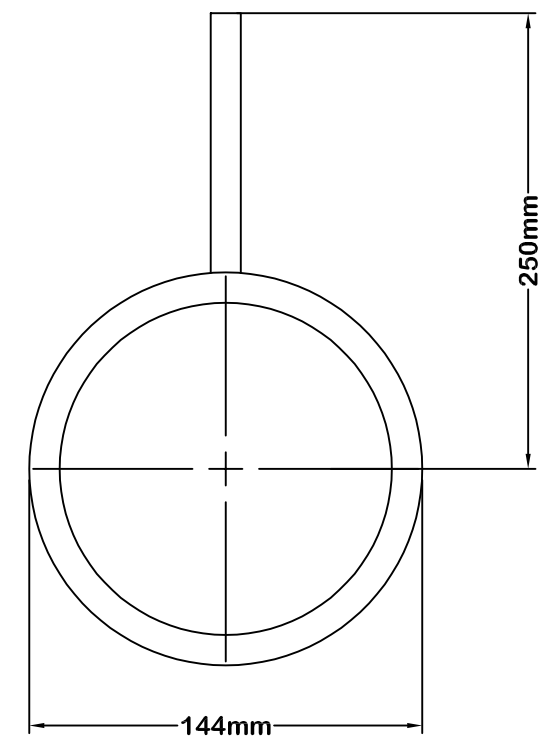

NOTES:

1. ALL UNITS TO BE SUPPLIED STAINLESS STEEL.
2. PROVIDE STAINLESS STEEL SWAY RINGS ON ALL FLOATS, MINIMUM 1.0m INTERVALS..

STAINLESS STEEL SWAY RING DETAIL FOR LEVEL FLOAT SWITCH



**PUBLIC WORKS
STANDARD DRAWING**

REV. DATE: JULY 2024

APPROVED BY
MM

DRAWN BY
ERAMOSA

**LEVEL FLOAT SWITCH
MOUNTING DETAILS**

STD. DWG. NUMBER
SPS-311

SCALE
Not to Scale