

APPENDIX

P

PRELIMINARY
ROAD DESIGN



APPENDIX

P-2

***COUNTRYSIDE
DRIVE
DRAWNINGS***

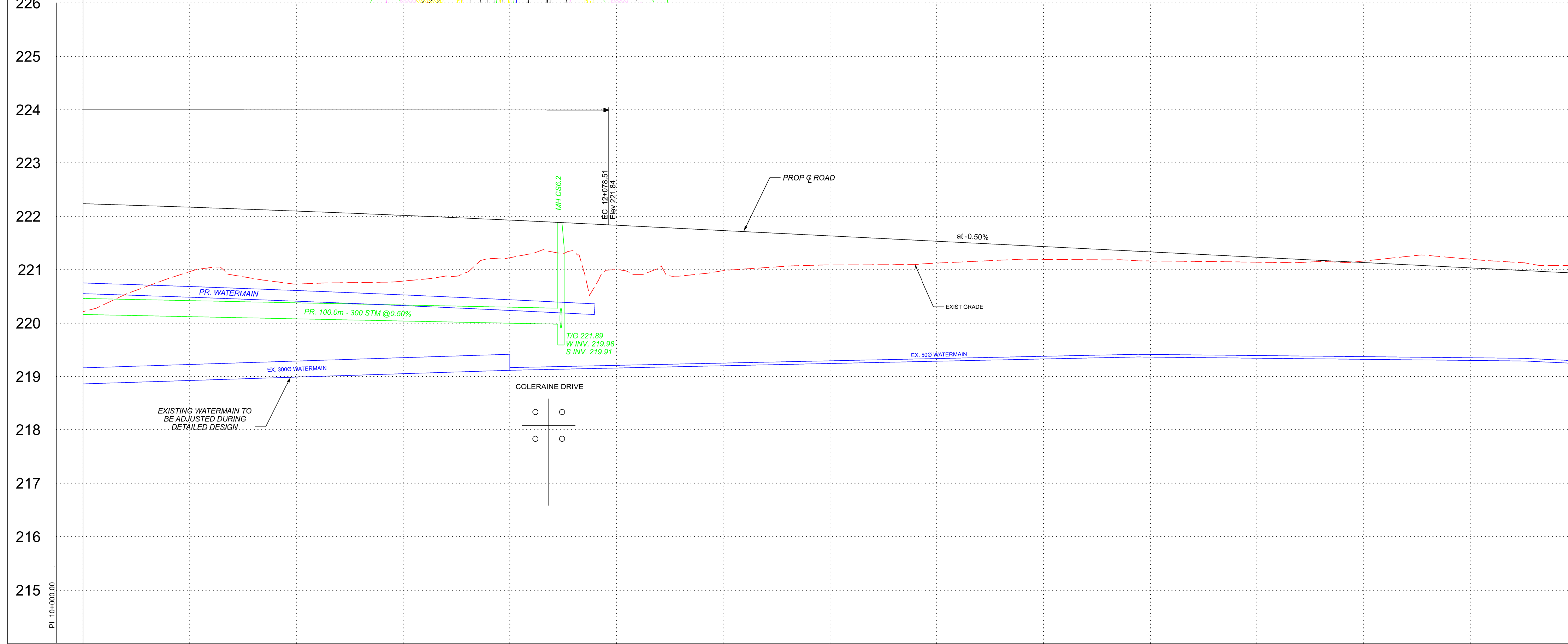
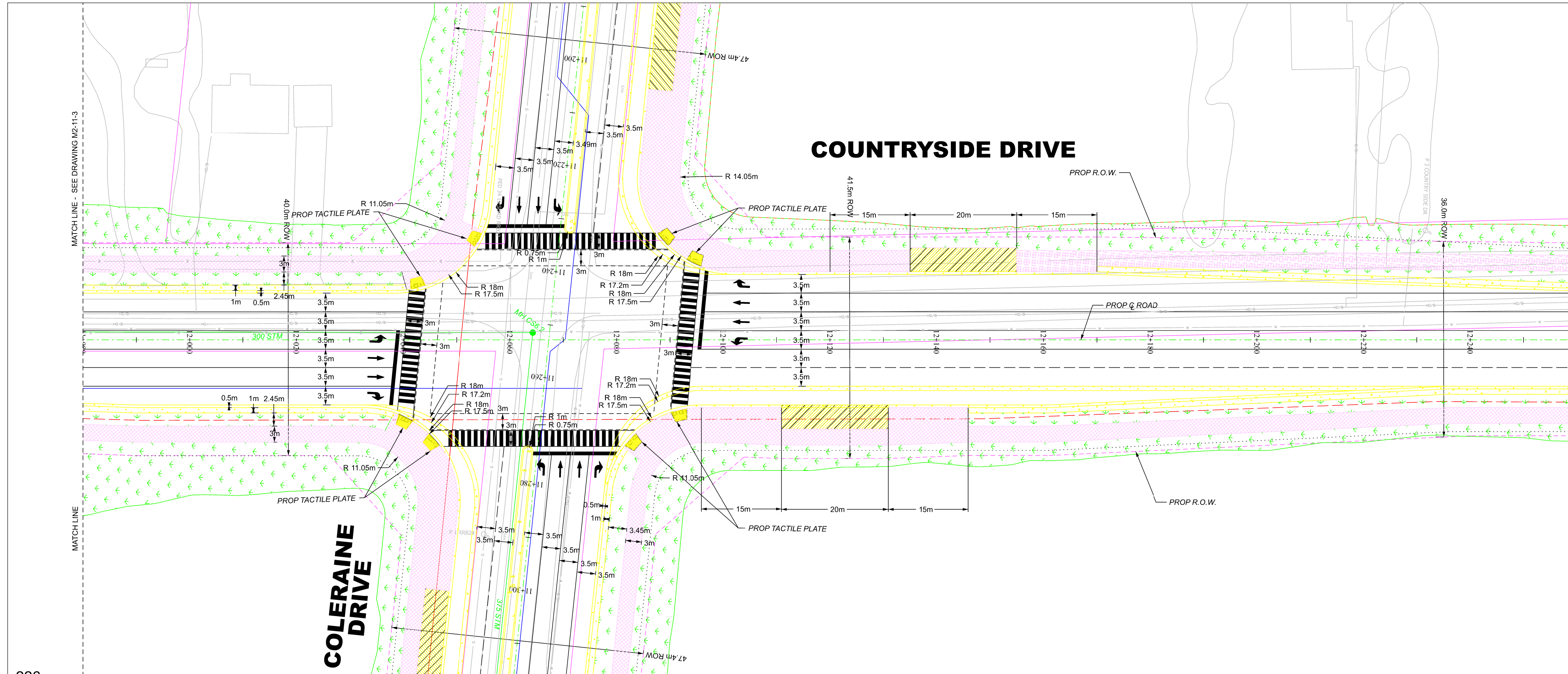

STATION	PROPOSED GRADES	SANITARY INVERT	STORM INVERT
12+000	222.17		
12+050	222.10		
12+100	222.02		
12+150	221.93		
12+200	221.83		
12+250	221.73		
12+300	221.63		
12+350	221.53		
12+400	221.43		
12+450	221.33		
12+500	221.23		
12+550	221.13		
12+600	221.03		
12+650	220.93		

FOR STORM AND ROADWORKS ONLY

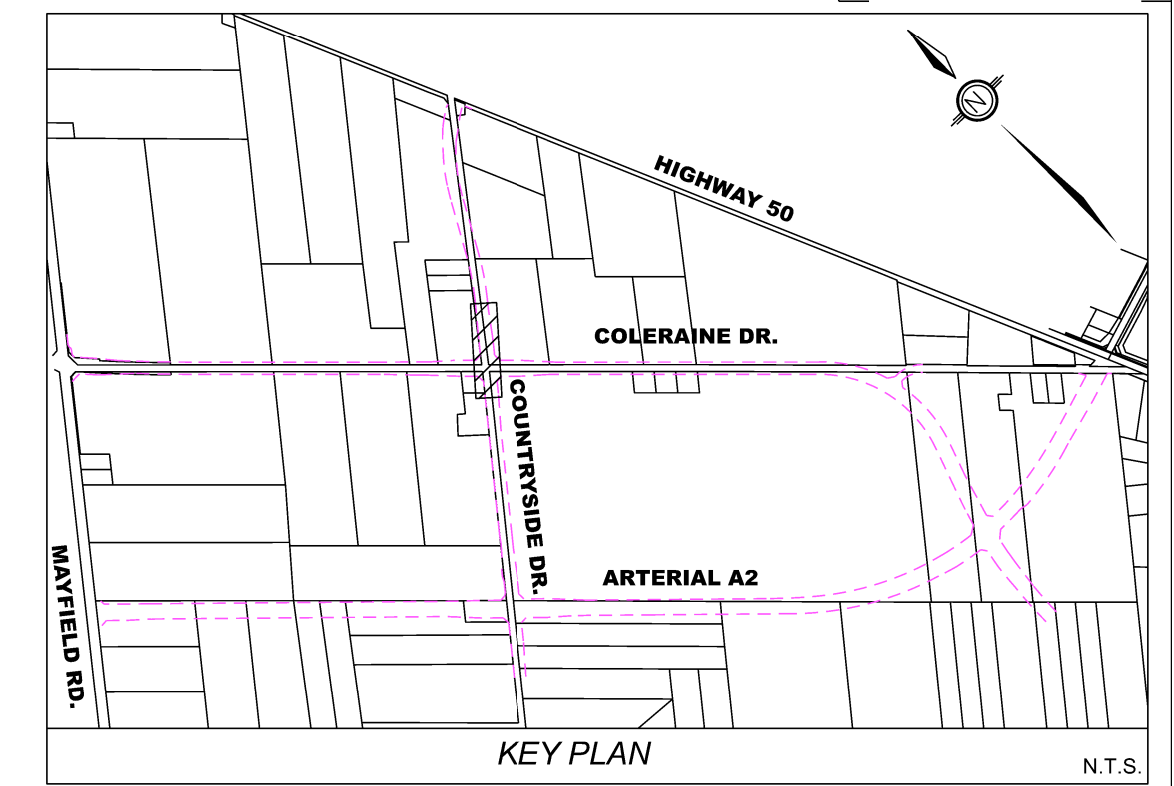

LEGEND:

PROP CONC BUS BAY	PROP SEED / SOD
PROP CONC KILLS/STRIP/MEDIAN	PROP IMPRESSED COLOURED CONC
PROP ASPHALT PAVEMENT	PROP ASPH MULTI USE TRAIL
PROP DW REINSTATEMENT	PROP DW RELOCATED / NEW
PROP STORM SEWER (PROFILE ONLY)	PROP TEMP ASPH PEDESTRIAN CONNECTION
PROP MILLING & PLACEMENT OF 40mm HLT	PROP SILT FENCE (TREE HOARDING)
PROP CONC SIDEWALK / BUS PAD	PROP LIMIT OF GRADING
PROP TACTILE WALKING STRIP INDICATOR	PROP TEMP ROCK CHECK DAM [DPSD 219.210]
EX SANITARY SEWER	EX OVERHEAD HYDRO
EX WATERMAIN	EX BELL
EX GAS	PROP OVERHEAD HYDRO
PROP WATERMAIN	PROP UNDERGROUND HYDRO
PROP SANITARY SEWER	PROP STORM SEWER

- NOTES:**
- ALL EXIST MH TOPS, GAS, WATER & OTHER APPURTENANCES TO BE ADJUSTED TO SUIT PROP GRADES
 - DCB & DIB LEADS TO BE 200mm, CB LEADS TO BE 200mm UNLESS OTHERWISE NOTED
 - ALL EXISTING CURBS WITHIN R.O.W. TO BE REMOVED UNLESS OTHERWISE NOTED
 - PROPOSED MEDIANS TO HAVE CONCRETE BARRIER CURB O.P.S.D. 600.080
 - PROPOSED CONCRETE KILLS/STRIP / MEDIAN SHALL BE DESIGNED TO 150mm CONCRETE 32MPa 200mm OF 20mm CRUSHER RUN LIMESTONE
 - ALL EXISTING UTILITY LOCATIONS ARE APPROXIMATE AND ARE TO BE CONFIRMED IN THE FIELD PRIOR TO CONSTRUCTION
 - FOR FINAL LAYOUT APPROVAL OF TRANSIT PADS PRIOR TO INSTALLATION, PLEASE CONTACT DAVID STOWE AT (905) 874-2750 EXT 62378 OR CHRIS LAFLEUR EXT 62620
 - CITY REFERS TO THE CITY OF BRAMPTON
 - SEE DRAWINGS --- FOR DIMENSIONS
 - SEE DRAWINGS --- FOR REMOVALS
 - SEE DRAWING --- FOR TYPICAL CROSS SECTIONS
 - SEE DRAWINGS --- FOR PAVEMENT ELEVATION DETAILS
 - SEE DRAWINGS --- FOR PAVEMENT MARKINGS AND SIGNAGE
 - SEE DRAWINGS --- FOR LANDSCAPING DRAWINGS
 - SEE DRAWINGS --- FOR STRUCTURAL DRAWINGS
- REFERENCE:** BENCH MARK F2-581 240.393m
One story brick building, no 43 Regan Road. Table is set in the southeast face of concrete foundation, 3.25m northeasterly of the southerly building corner and 0.15m above the sidewalk.



NO.	M.K.	DATE	ISSUED FOR 30% REVIEW	REVISIONS	M.K.	CHECKED
01	M.K.	JULY 27, 2022	ISSUED FOR 30% REVIEW		M.K.	CHECKED

BRAMPTON Flower City
Region of Peel working with you
wood.
Public Works & Engineering
Capital Works

PROJECT	DWG. NO.		
---------	----------	--	--

COUNTRYSIDE DRIVE
STA. 11+980 TO STA. 12+260

PROPOSED RECONSTRUCTION

SURVEYED BY: BRAMPTON	DATE: JULY 27, 2022	FILE NO.	xxxxxx
DRAWN BY: D. TUNO	CHECKED BY: M. KHAN	DRAWING NO.	
DESIGNED BY: M. KHAN	CHECKED BY: M. KHAN		
SCALE: v 1:50 h 1:500	DATE: JULY 27, 2022		

XX-XX-XX

FOR STORM AND ROADWORKS ONLY

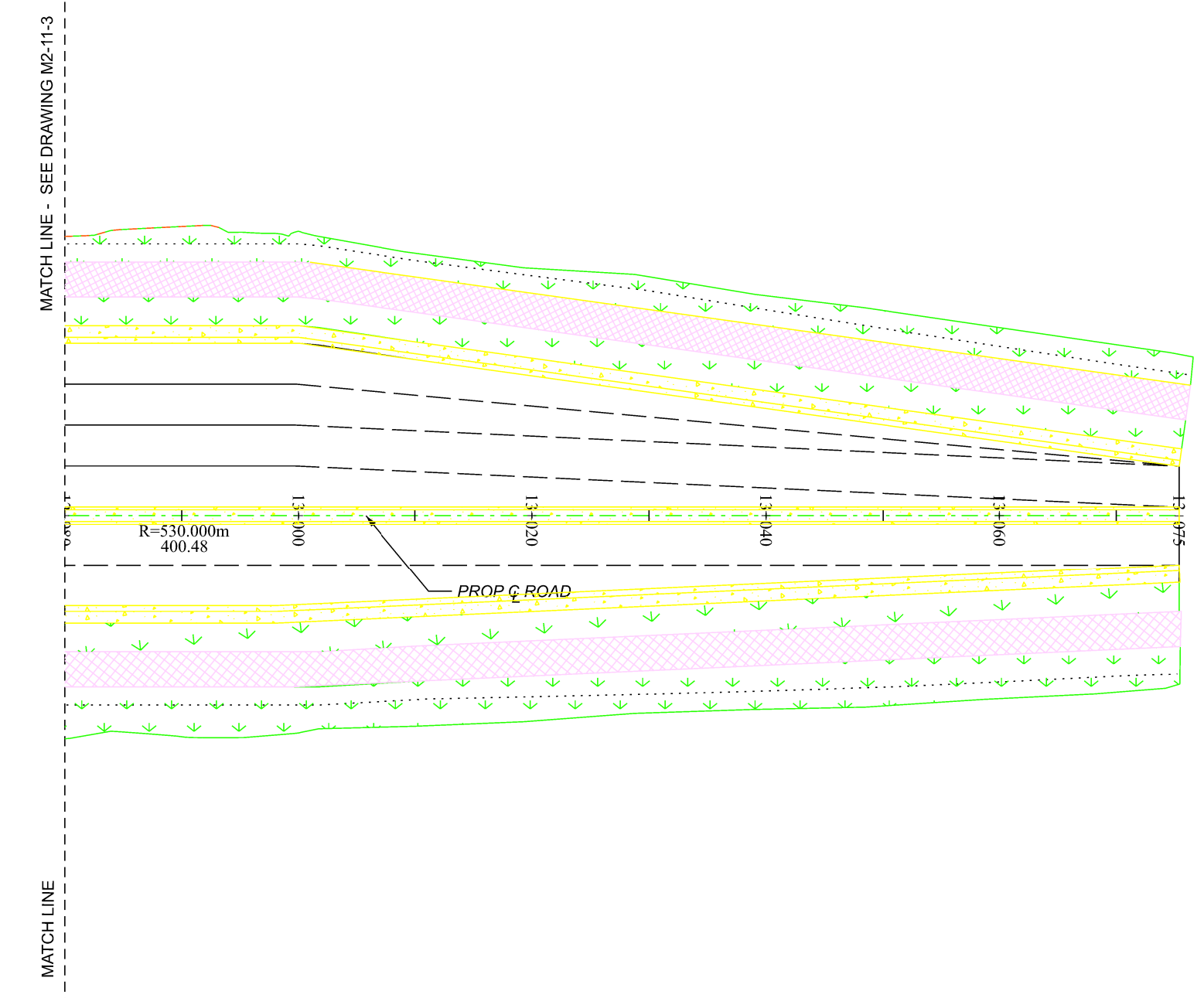
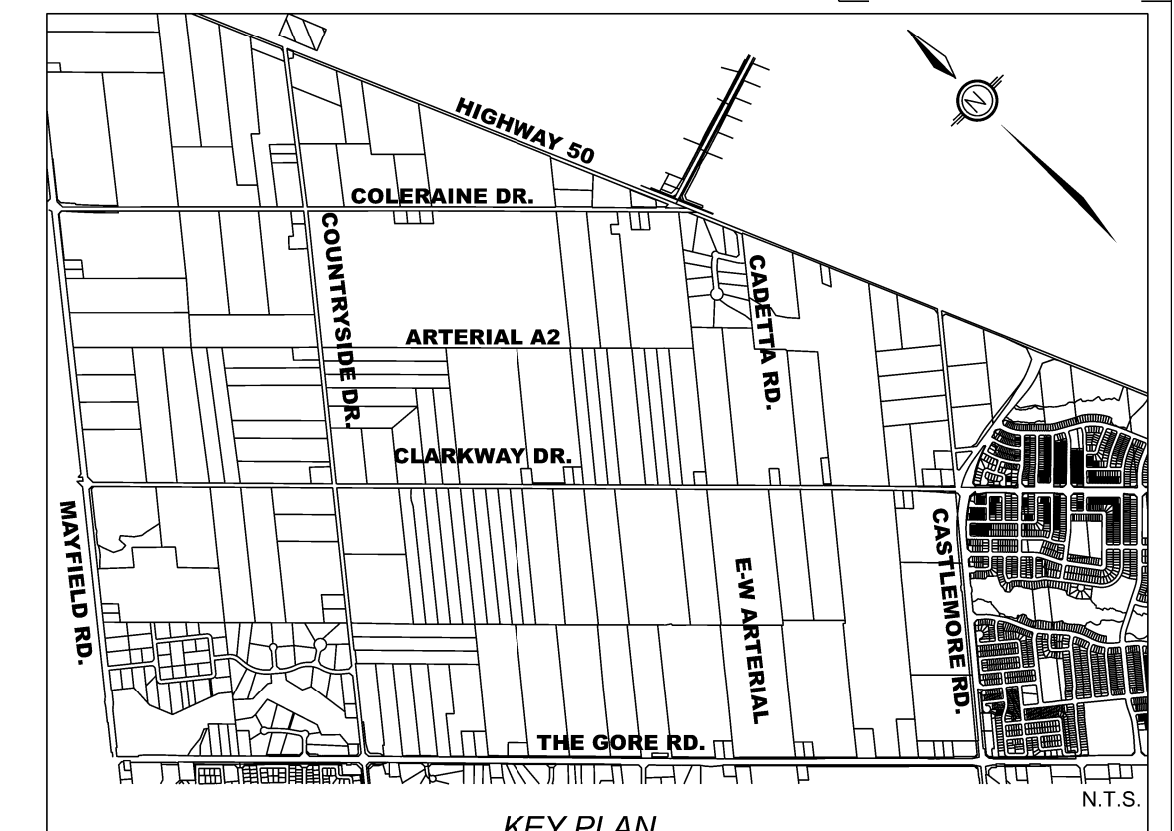
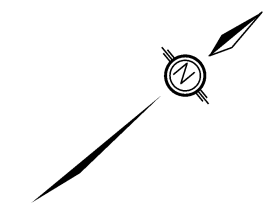

LEGEND:

PROP CONC BUS BAY	PROP SEED / SOD
PROP CONC KILLSTRIP/MEDIAN	PROP IMPRESSED COLOURED CONC
PROP ASPHALT PAVEMENT	PROP ASPH MULTI USE TRAIL
PROP DW REINSTATEMENT	PROP DW RELOCATED / NEW
PROP STORM SEWER (PROFILE ONLY)	PROP TEMP ASPH PEDESTRIAN CONNECTION
PROP MILLING & PLACEMENT OF 40mm HLT	PROP SILT FENCE (TREE HOARDING)
PROP CONC SIDEWALK / BUS PAD	PROP LIMIT OF GRADING
PROP TACTILE WALKING STRIP INDICATOR	PROP TEMP ROCK CHECK DAM [DPSD 219.210]
EX SANITARY SEWER	EX OVERHEAD HYDRO
EX WATERMAIN	EX BELL
EX GAS	PROP OVERHEAD HYDRO
PROP WATERMAIN	PROP UNDERGROUND HYDRO
PROP SANITARY SEWER	PROP STORM SEWER

- NOTES:**
- ALL EXIST MH TOPS, GAS, WATER & OTHER APPURTENANCES TO BE ADJUSTED TO SUIT PROP GRADES
 - DCB & DCB LEADS TO BE 200mm, CB LEADS TO BE 200mm, UNLESS OTHERWISE NOTED
 - ALL EXISTING CURBS WITHIN E.O.W. TO BE REMOVED UNLESS OTHERWISE NOTED
 - PROPOSED MEDIANS TO HAVE CONCRETE BARRIER CURB C.P.S.D. 800.080
 - PROPOSED CONCRETE KILLSTRIP / MEDIAN SHALL BE DESIGNED TO 150mm CONCRETE 32MPa 200mm OF 20mm CRUSHER RUN LIMESTONE
 - ALL EXISTING UTILITY LOCATIONS ARE APPROXIMATE AND ARE TO BE CONFIRMED IN THE FIELD PRIOR TO CONSTRUCTION
 - FOR FINAL LAYOUT APPROVAL OF TRANSIT PADS PRIOR TO INSTALLATION, PLEASE CONTACT DAVID STOWE AT (905) 874-2750 EXT 62378 OR CHRIS LAFLEUR EXT 62620
 - CITY REFERS TO THE CITY OF BRAMPTON
 - SEE DRAWINGS - - - FOR DIMENSIONS
 - SEE DRAWINGS - - - FOR REMOVALS
 - SEE DRAWING - - - FOR TYPICAL CROSS SECTIONS
 - SEE DRAWINGS - - - FOR PAVEMENT ELEVATION DETAILS
 - SEE DRAWINGS - - - FOR PAVEMENT MARKINGS AND SIGNAGE
 - SEE DRAWINGS - - - FOR LANDSCAPING DRAWINGS
 - SEE DRAWINGS - - - FOR STRUCTURAL DRAWINGS
- REFERENCE:** BENCH MARK F2-581 240.393m
One story brick building, no 43 Regan Road. Tablet is set in the southeast face of concrete foundation, 3.25m northeasterly of the southerly building corner and 0.15m above the sidewalk.

60m 50m 40m 30m 20m 10m 0m 5m 10m

NO.	M.K.	DATE	REVISIONS	CHECKED
01	M.K.	15NOV19	ISSUED FOR 30% REVIEW	M.K.

BRAMPTON Region of Peel
Flower City working with you

Public Works & Engineering
Capital Works

wood.

PROJECT DWG. NO.

COUNTRYSIDE DRIVE
STA. 13+000 TO 13+001.46

Description

PROPOSED RECONSTRUCTION

SURVEYED BY: BRAMPTON	DATE: NOVEMBER 15, 2019	FILE NO.:	xxxxxx
DRAWN BY: A. KARAMBAKSHIAN	CHECKED BY: M. KHAN	DRAWING NO.:	SHEET NO.
DESIGNED BY: M. KHAN	CHECKED BY: M. KHAN	XX-XX-XX	
SCALE: v 1:50 h 1:500	DATE: 15 NOV 19		