

CHAMBER SIZE	NUMBER OF FROST STRAPS
1800x2400	6
1800x3000	6
2400x3000	6
2400x3800	6
3000x3800	6
3000x4400	8
3000x5000	8

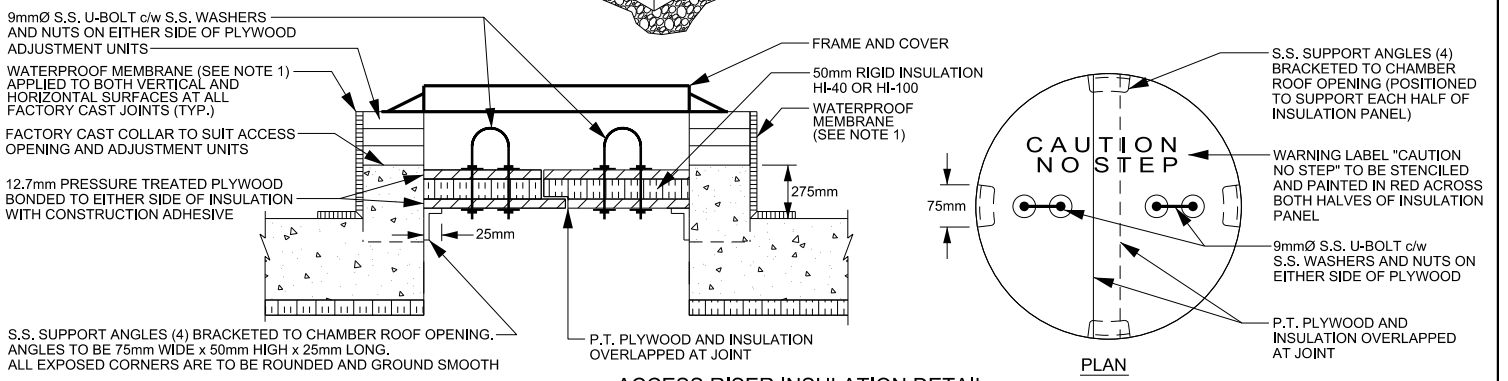

ACCESS RISER INSULATION DETAIL

NOTE

1. WATERPROOF MEMBRANE TO BE "MEL-ROL" BY W.R. MEADOWS OF MILTON ONTARIO OR APPROVED EQUAL. EXTEND COMPLETELY AROUND ALL RISER SECTION JOINTS WITH A MINIMUM 300mm WIDE STRIP.
2. ALL INSULATION TO BE RIGID TYPE EXTRUDED POLYSTYRENE FOAM DOW HI-40 OR HI-100 OR APPROVED EQUAL. ALL CHAMBER INSULATION TO BE INSTALLED WITH CONSTRUCTION ADHESIVE AND TAPCON ANCHORS AT MAX. 600mm SPACING IN ALL DIRECTIONS (MIN. 2 ANCHORS PER SHEET OF INSULATION).



PUBLIC WORKS
STANDARD DRAWING

REV. DATE: APRIL 2014

APPROVED BY

DRAWN BY

A.P.

AINLEY GROUP

TYPICAL PRECAST RECTANGULAR CHAMBER DETAILS
FOR NEW WATERMAINS

STD. DWG. NUMBER

SCALE

1-1-6

N.T.S.