

LEGEND

—— PROP. WATERMAIN

SHARLYN ROAD

FROM LENWORTH DRIVE TO WHARTON WAY

COUNCILLOR: CHRIS FONSECA

PHONE: 905-791-7800 EXT: 4409

EMAIL: construction@peelregion.ca

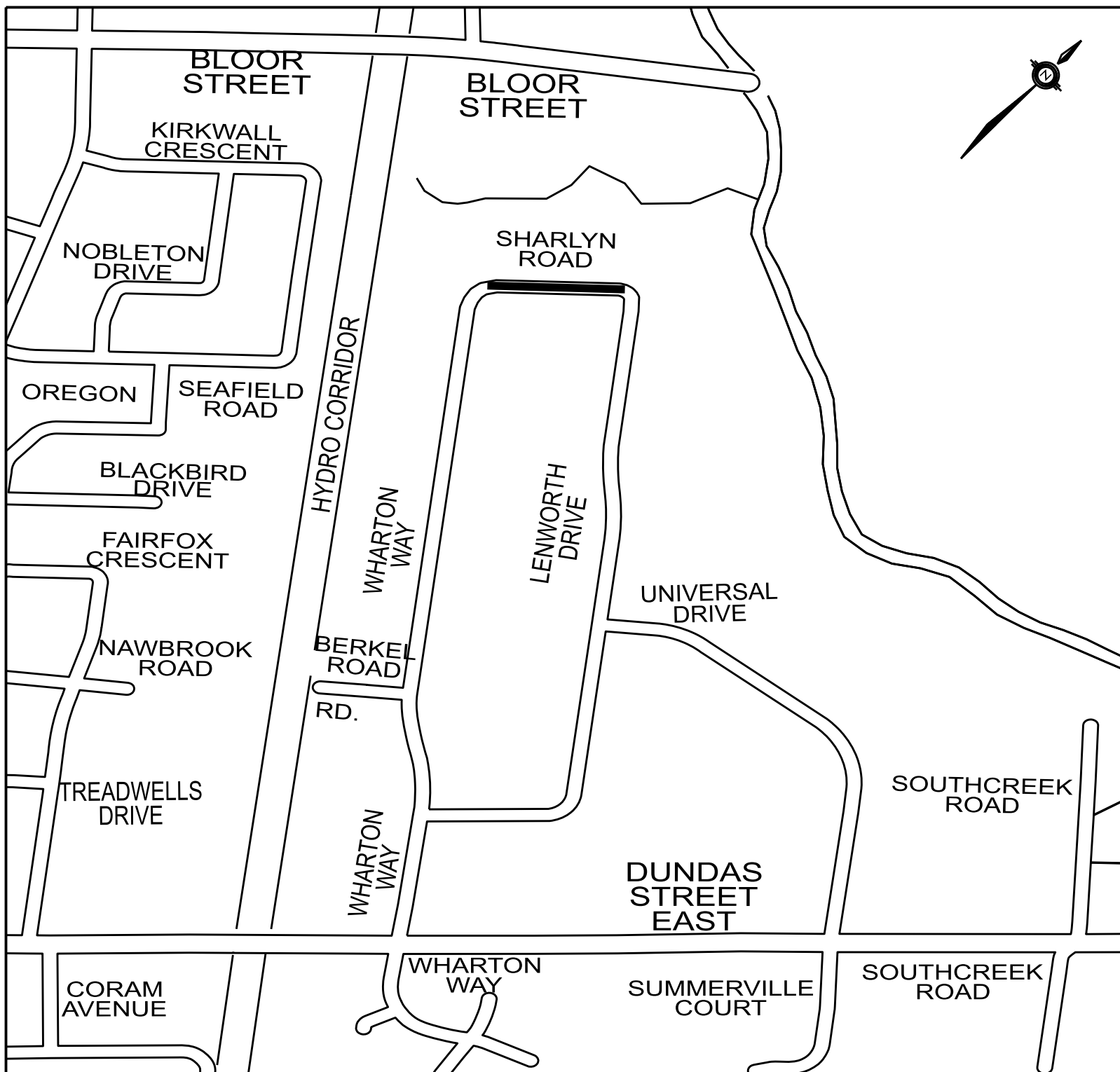

PUBLIC WORKS

10 PEEL CENTRE DRIVE - SUITE B, 4th FLOOR, BRAMPTON ON L6T 4B9 (905) 791-7800

LEGEND

—— PROP. WATERMAIN

LENWORTH DRIVE

FROM WHARTON WAY TO SHARLYN ROAD

COUNCILLOR: CHRIS FONSECA

PHONE: 905-791-7800 EXT: 4409

EMAIL: construction@peelregion.ca

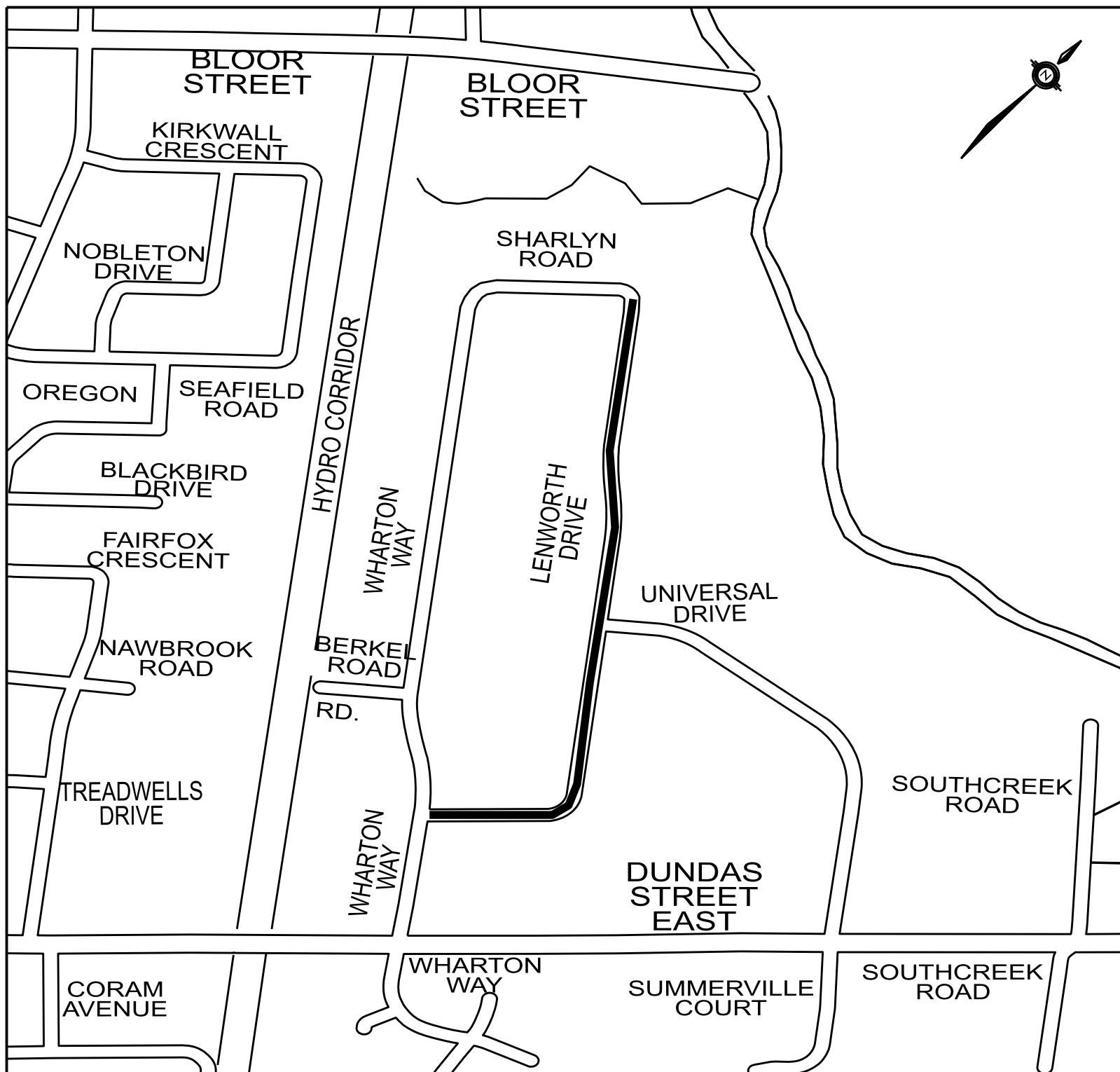

PUBLIC WORKS

10 PEEL CENTRE DRIVE - SUITE B, 4th FLOOR, BRAMPTON ON L6T 4B9 (905) 791-7800

LEGEND

— PROP. WATERMAIN

BERKEL ROAD

FROM WHARTON WAY TO END

COUNCILLOR: CHRIS FONSECA

PHONE: 905-791-7800 EXT: 4409

EMAIL: construction@peelregion.ca

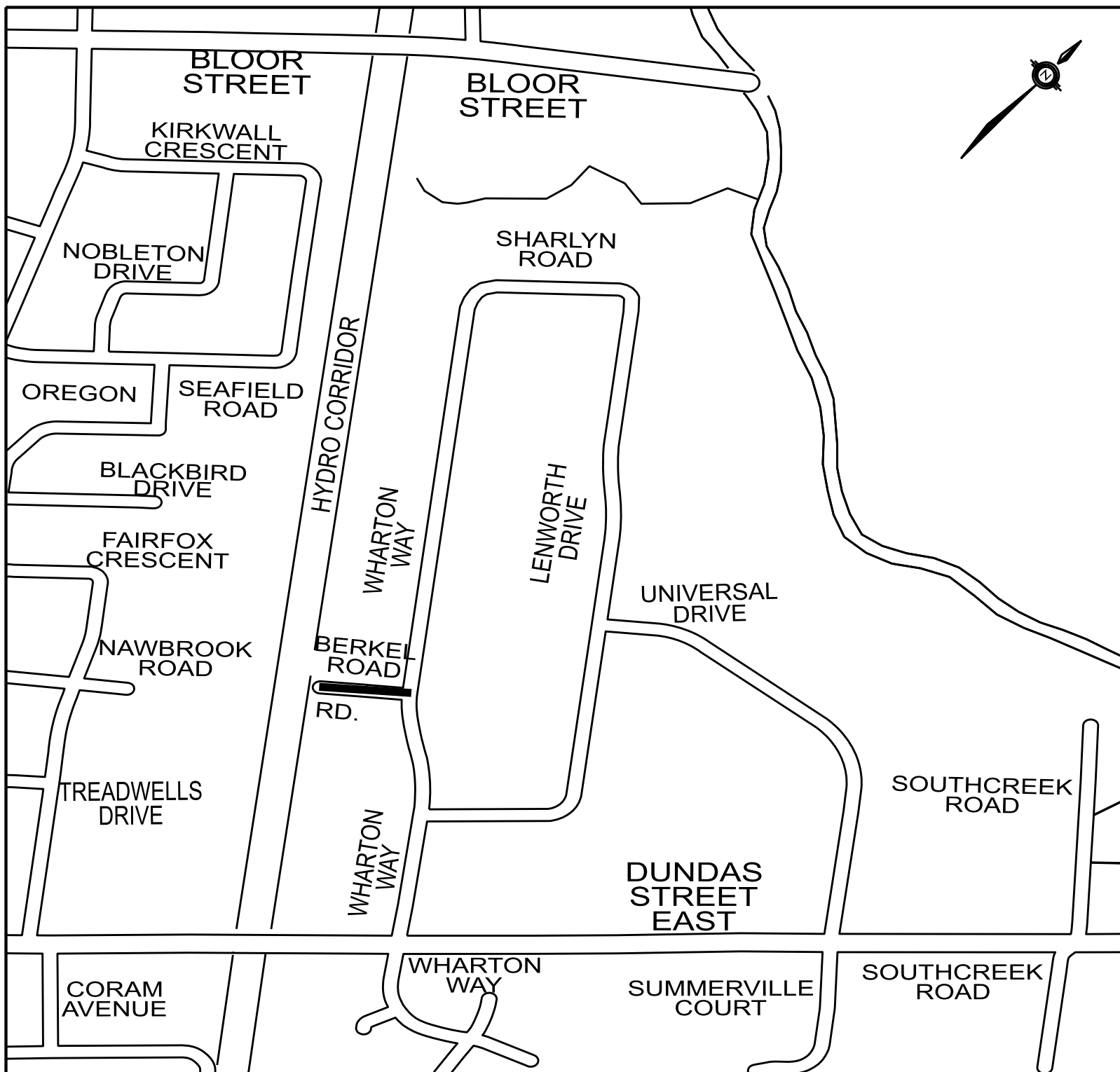

PUBLIC WORKS

10 PEEL CENTRE DRIVE - SUITE B, 4th FLOOR, BRAMPTON ON L6T 4B9 (905) 791-7800

LEGEND

— PROP. WATERMAIN

WHARTON WAY

FROM BERKEL ROAD TO DUNDAS ST. E

COUNCILLOR: CHRIS FONSECA

PHONE: 905-791-7800 EXT: 4409

EMAIL: construction@peelregion.ca

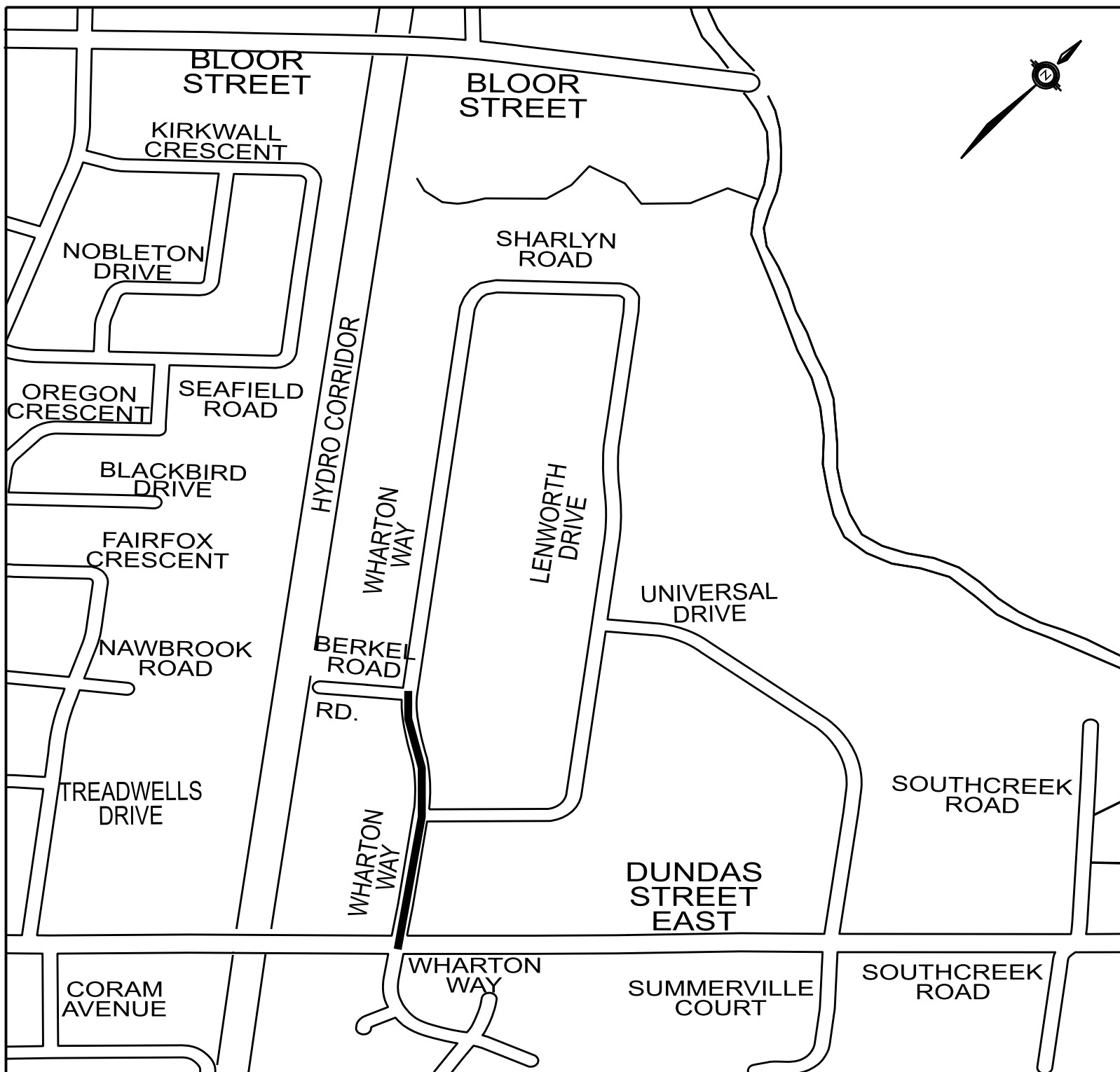

PUBLIC WORKS

10 PEEL CENTRE DRIVE - SUITE B, 4th FLOOR, BRAMPTON ON L6T 4B9 (905) 791-7800

LEGEND

— PROP. WATERMAIN

**AUDUBON BOULEVARD
FROM CLAYPINE RISE TO FIELDGATE DRIVE**

COUNCILLOR: CHRIS FONSECA

**PHONE: 905-791-7800 EXT: 4409
EMAIL: construction@peelregion.ca**

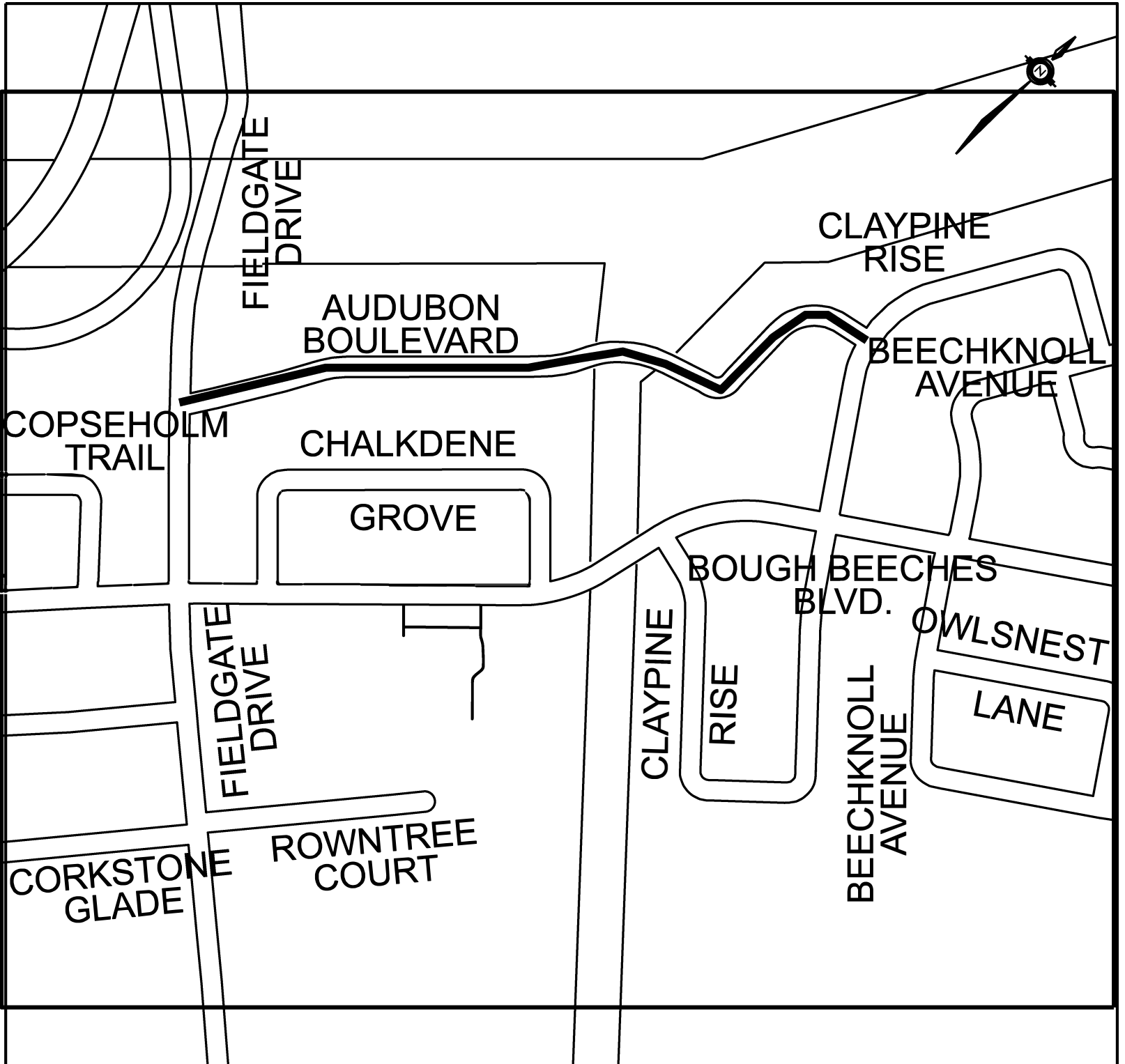



working with you

CLAYPINE RISE (SOUTH LEG)

FROM BOUGH BEECHES BOULEVARD.
TO BOUGH BEECHES BOULEVARD.

COUNCILLOR: CHRIS FONSECA

PHONE: 905-791-7800 EXT: 4409

EMAIL: construction@peelregion.ca

LEGEND

—— PROP. WATERMAIN

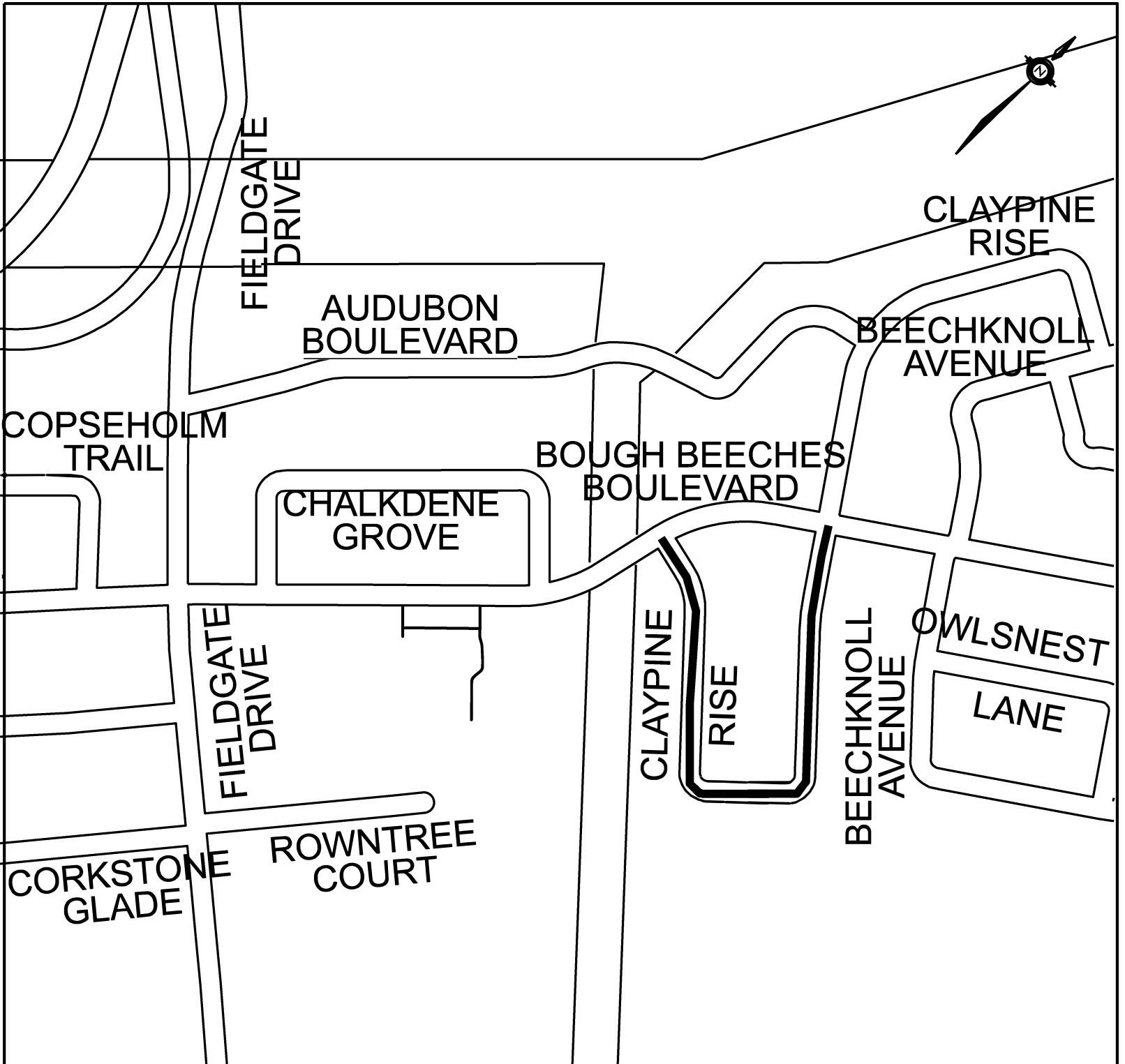

PUBLIC WORKS

10 PEEL CENTRE DRIVE - SUITE B, 4th FLOOR, BRAMPTON ON L6T 4B9 (905) 791-7800

LEGEND

—— PROP. WATERMAIN

**HILLMAN CRESCENT
FROM RYMAL ROAD TO RYMAL ROAD**

COUNCILLOR: CHRIS FONSECA

**PHONE: 905-791-7800 EXT: 4409
EMAIL: construction@peelregion.ca**

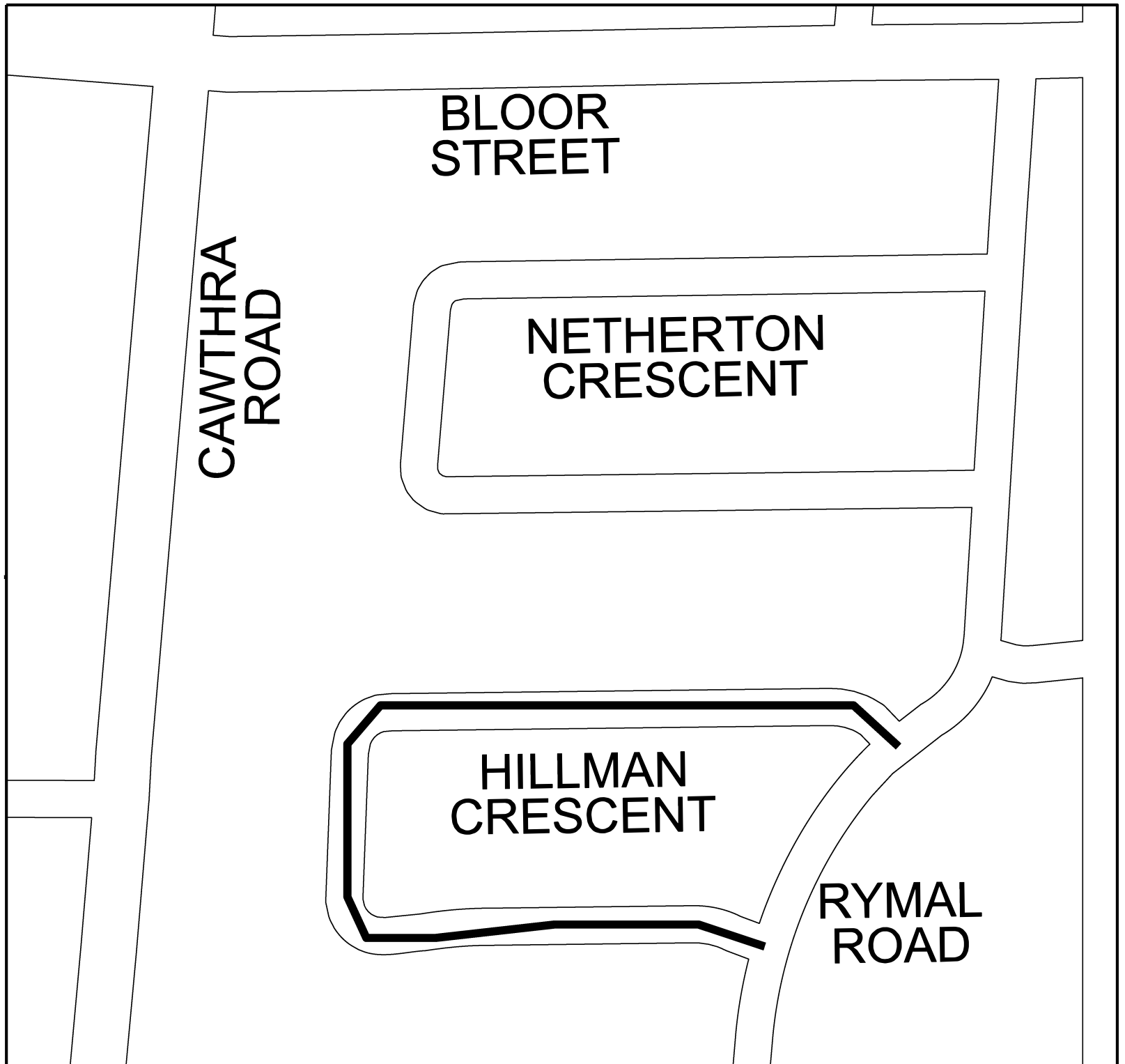

LEGEND

—— PROP. WATERMAIN

CARAVELLE DRIVE

FROM UNIT 3130 TO NORTHWEST DRIVE

COUNCILLOR: CAROLYN PARRISH

PHONE: 905-791-7800 EXT: 4409

EMAIL: construction@peelregion.ca

