

## LEGEND

PROP. WATERMAIN



**PROJECT 19-1340B**

## **BRAMALEA ROAD FROM BOVAIRD DRIVE TO SANDALWOOD PARKWAY**

**COUNCILLOR : G. DHILLON , WARD 9**

**PHONE: 905-791-7800 EXT: 4409**

**EMAIL: [construction@peelregion.ca](mailto:construction@peelregion.ca)**

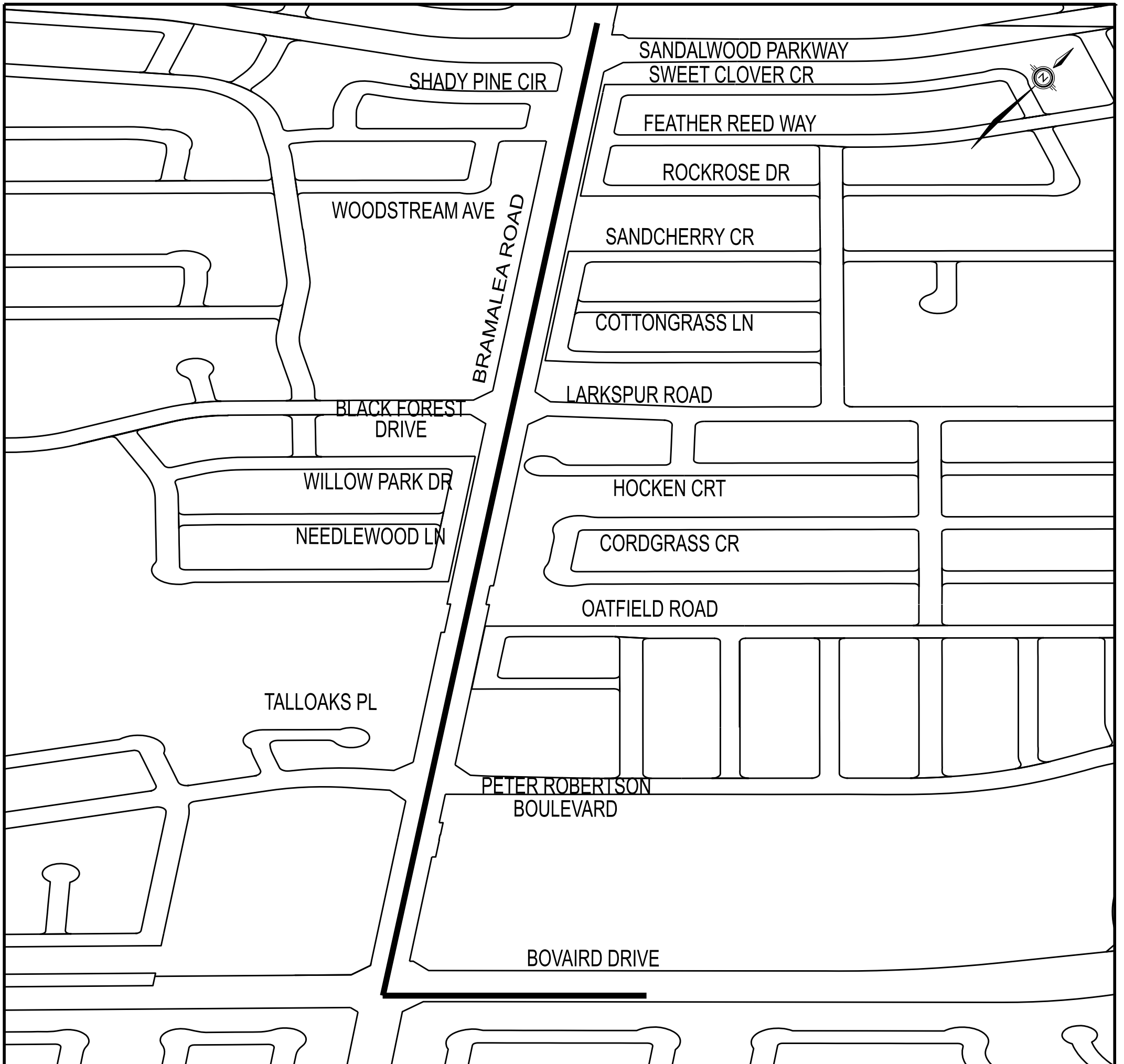

**PUBLIC WORKS**

**10 PEEL CENTRE DRIVE - SUITE B, 4th FLOOR, BRAMPTON ON L6T 4B9 (905) 791-7800**