



working with you

# SHERIDAN PARK MULTI-USE TRAIL SOUTH OF HERRIDGE PUMPING STATION

PROJECT 13-1347H3

## LEGEND

PATH CLOSURE    - - - - -

WARD 2

PHONE: 905-791-7800 EXT: 4409

EMAIL: [construction@peelregion.ca](mailto:construction@peelregion.ca)

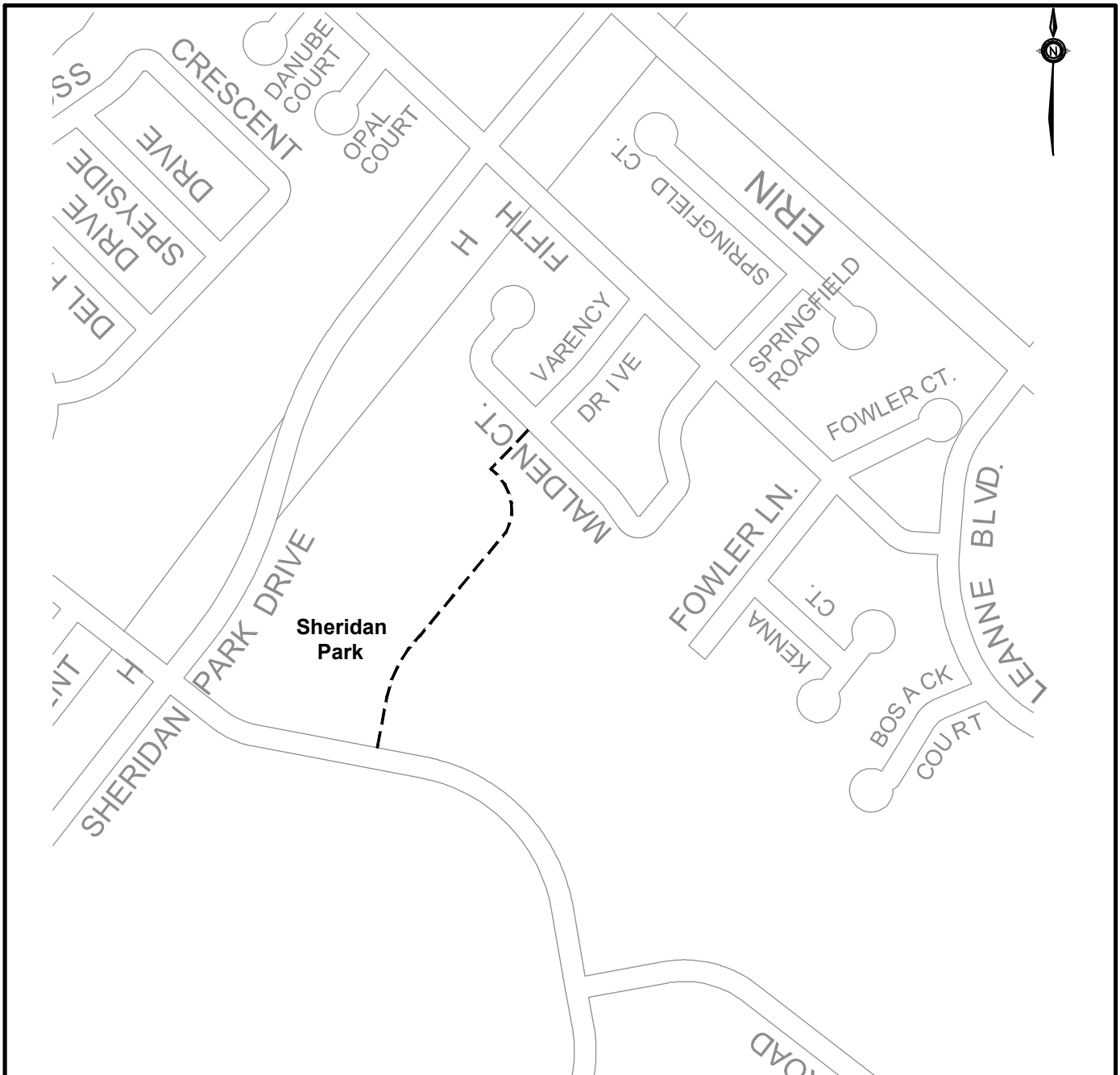

**PUBLIC WORKS**  
10 PEEL CENTRE DRIVE - SUITE A, 4TH FLOOR, BRAMPTON ON L6T 4B9 (905) 791-7800