

BRACKET ELEVATION

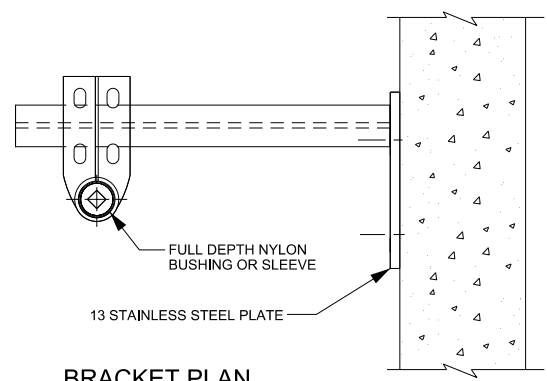
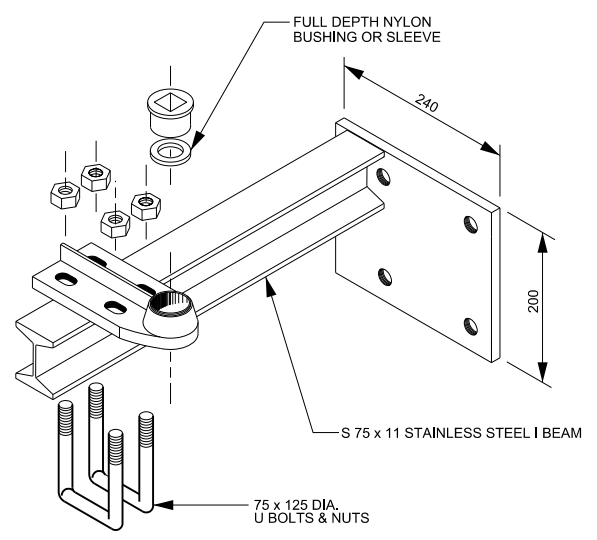

BRACKET PLAN

NOTE

1. STEM EXTENSION BRACKET AND ALL COMPONENTS AND FASTENERS TO BE STAINLESS STEEL.
2. ON EXISTING CHAMBERS FASTEN BRACKET TO WALL USING 15 DIA.x 75 LONG SCREWS WITH 75 LONG EXPANSION SHIELDS.
3. ON PROPOSED CHAMBERS FASTEN BRACKET TO WALL USING 15 DIA.x 200 LONG BOLTS WITH WASHERS AND NUTS.
4. STEM EXTENSION BRACKET ONLY TO USED WHEN DEPTH EQUALS OR EXCEEDS 1.5m FROM SURFACE.
5. ADJUSTMENT TO BE MADE IN ORDER TO BRING OPERATING NUT TO 150mm FROM FINAL GRADE WITHIN VALVE BOX.



**PUBLIC WORKS
STANDARD DRAWING**

REV. DATE: APRIL 2014

APPROVED BY

DRAWN BY

A.P.

AINLEY GROUP

STD. DWG. NUMBER

SCALE

1-2-4

N.T.S.

**VALVE STEM EXTENSION
AND BRACKET**